

Memo

Department of Corporate Services

To: For Circulation See Below

Property Commercial & Development
Legal and Democratic Services

EMAILED

City Hall

Bradford

West Yorkshire

BD1 1HY

DX11758 BRADFORD -1

Ref: 16/00013/A

From: Stephen P Nelson

Legal Officer

Property Commercial & Development

Law Team

Date: 31st January 2017

Tel: (01274) 432083

Fax: (01274) 432116

My Ref: CORP/PCD/SPN/LD/73337

Email: stephen.nelson@bradford.gov.uk

TOWN AND COUNTRY PLANNING ACT 1990 - SECTION 198 LAND AT HOLME ROYD, WOODVILLE ROAD, KEIGHLEY - TREE PRESERVATION ORDER

The above Tree Preservation Order was confirmed on 31st January 2017. Please find attached a copy for your records.

Stephen P Nelson
Legal Officer

Enc

Arboricultural Technician
Development Services Tree Section
Department of Regeneration
4th Floor, Britannia House
Simon Keenan

Land Charges Manager
Local Land Charges
Britannia House

For TPO's in Keighley Area (including Addingham)
Elisabeth Spencer
Keighley Customer Services Centre
Ground Floor
Keighley Town Hall

(Document)

G:\DEVELOPMENT\STDS\TP17.DOT (Revised October 2015)



TOWN AND COUNTRY PLANNING ACT 1990
LAND AT HOLME ROYD WOODVILLE ROAD KEIGHLEY
TREE PRESERVATION ORDER 2016

The City of Bradford Metropolitan District Council in exercise of the powers conferred on them by Section 198 of the Town and Country Planning Act 1990 make the following Order:-

Citation

1. This Order may be cited as "Land at Holme Royd Woodville Road Keighley".

Interpretation

2. (1) In this Order "the authority" means City of Bradford Metropolitan District Council.
- (2) In this Order any reference to a numbered section is a reference to the section so numbered in the Town and Country Planning Act 1990 and any reference to a numbered regulation is a reference to the regulation so numbered in the Town and Country Planning Act (Tree Preservation) (England) Regulations 2012.

Effect

3. (1) Subject to article 4, this Order takes effect provisionally on the date on which it is made.
- (2) Without prejudice to subsection (7) of section 198 (power to make tree preservation orders) or subsection (1) of section 200 (tree preservation orders: Forestry Commissioners) and, subject to the exception in regulation 14, no person shall:-
 - (a) cut down, top, lop, uproot, wilfully damage, or wilfully destroy; or
 - (b) cause or permit the cutting down, topping, lopping, wilful damage or wilful destruction of,

any tree specified in the Schedule to this Order except with the written consent of the authority in accordance with regulations 16 and 17, or of the Secretary of State in accordance with regulation

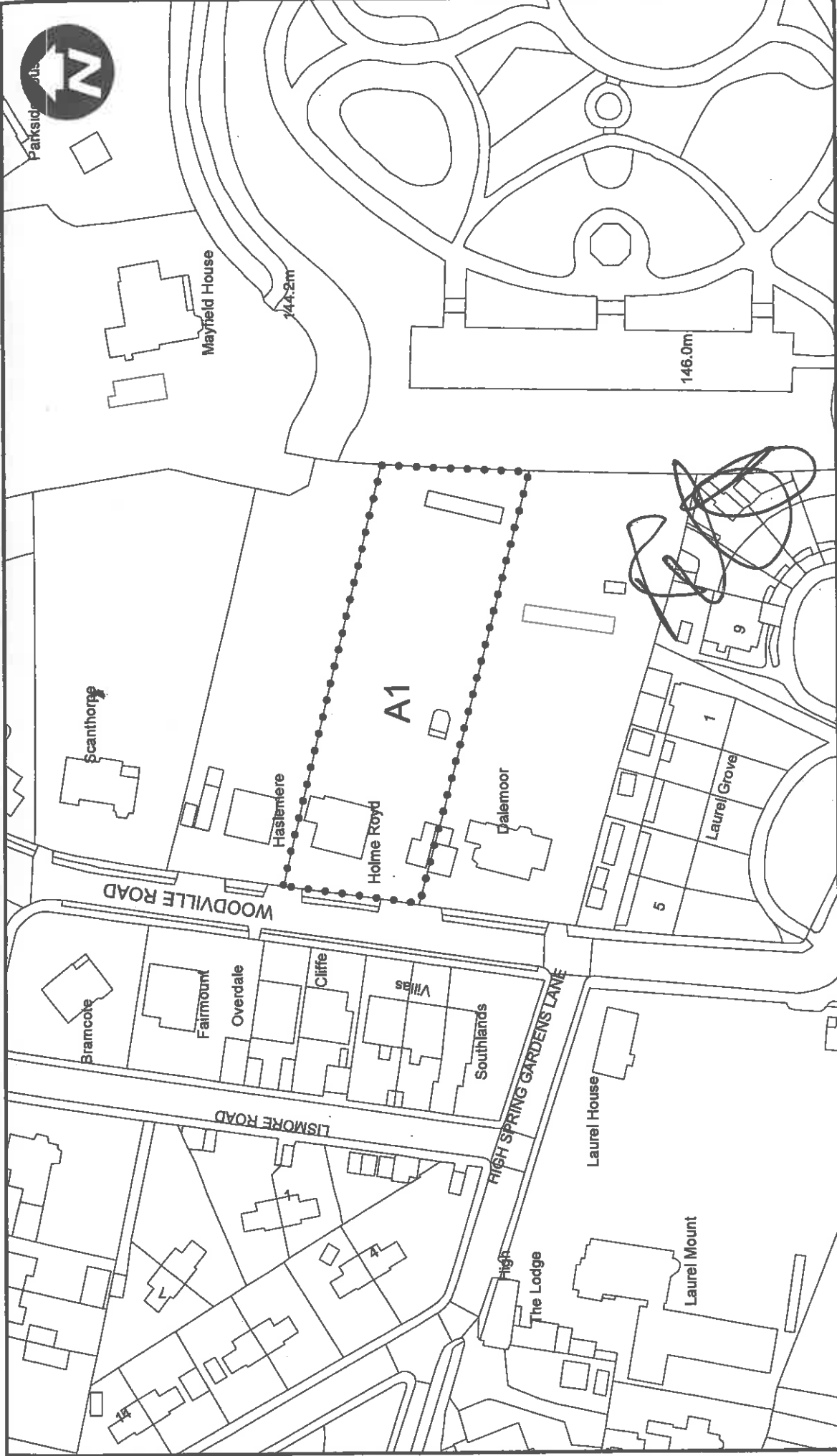

OS Ref : SE0541
 Reproduced from the Ordnance Survey map with
 the sanction of HM Stationary Office
 Crown Copyright reserved
 LA076120
 Scale 1 : 1,250

TREE PRESERVATION ORDER
 16/00013/A
 LAND AT HOLME ROYD
 WOODVILLE ROAD
 KEIGHLEY

DEPARTMENT OF REGENERATION & CULTURE
 Jacobs Well
 Bradford
 BD1 5RW

DECISION NOT TO CONFIRM

A decision not to confirm this Order was taken by the City of Bradford Metropolitan District Council on the day of

EXECUTED AS A DEED by affixing
THE COMMON SEAL of
THE CITY OF BRADFORD METROPOLITAN DISTRICT COUNCIL
in the presence of:-

Authorised by the City Solicitor

VARIATION OF ORDER

This Order was varied by the City of Bradford Metropolitan District Council on the day of by a variation order under reference number a copy of which is attached.

EXECUTED AS A DEED by affixing
THE COMMON SEAL of
THE CITY OF BRADFORD METROPOLITAN DISTRICT COUNCIL
in the presence of:-

Authorised by the City Solicitor

REVOCATION OF ORDER

This Order was revoked by the City of Bradford Metropolitan District Council on
the day of

EXECUTED AS A DEED by affixing
THE COMMON SEAL of
THE CITY OF BRADFORD METROPOLITAN DISTRICT COUNCIL
in the presence of:-

Authorised by the City Solicitor

SCHEDULE**Specification of Trees****Trees specified individually**

(encircled in black on the map)

Reference on map	Description	Situation
None		

Trees specified by reference to an area

(within a dotted black line on the map)

Reference on map	Description	Situation
A1	All trees of whatever species	SE 0541

Groups of trees

(within a broken black line on the map)

Reference on map	Description	Situation
None		

Woodlands

(within a continuous black line on the map)

Reference on map	Description	Situation
None		